

Instructions for Gasketed Joint System with our TriSeal®

Atkore™
FRE Composites

FRE® Conduit's Bell and Spigot design incorporates a factory installed one piece molded urethane TriSeal® gasket, making the FRE® Conduit system simple and easy to install. Assembly does not require adhesives; cutting, threading or tapering, or any specialized equipment or skills. Pullout strength is approximately 500 lb. (227 kg) when installed correctly.

Assembly is in three (3) simple steps :

- ▶ Ensure gasket is in place and the Bell and Spigot are free from foreign objects.
- ▶ Align and insert Spigot into the mating Bell until the Spigot contacts the TriSeal® gasket.
- ▶ Place a wood block against the opposite Bell end. Strike the block, until the Spigot is engaged to the drive line (factory marked line on the conduit spigot). Please note that in space restricted working areas, water based lubricant (soapy water), applied to the spigot, will help make assembly easier.

** Note: Do not force Spigot too far into the Bell as this may cause damage to the conduit system.

Instructions

Even if the TriSeal® gaskets were correctly installed at the factory, it is occasionally possible for a gasket to be dislodged from its installed position by rough handling during shipment. The installer should verify the inclusion of gaskets at every section of conduit or fitting is installed. When a TriSeal® gasket has inadvertently fallen out, the following procedures will ensure its correct replacement in the fitting.

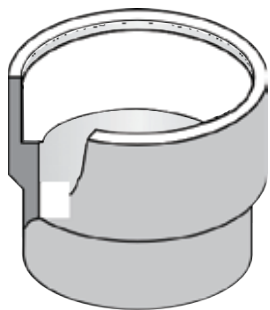

1. Examine the ledge inside the fitting to ensure that is free of dirt and debris.

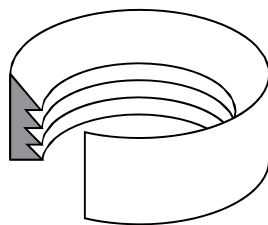

2. Obtain the TriSeal® and check that it is in the correct configuration with the ribs pointing inside. (If the TriSeal® is not in the correct orientation, twist it inside out to correct it.)

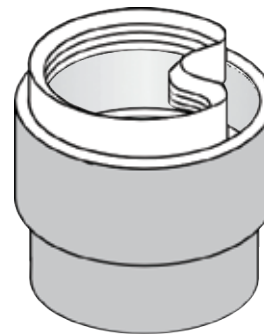

3. Deform the TriSeal® into a kidney shape and place it (flat end first) into the fitting. When in position, snap the seal in place against the fitting along its entire circumference.

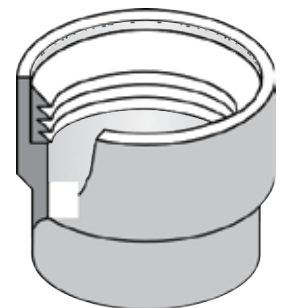

4. Depress the seal to ensure that it is correctly seated against the ledge of the fitting.



For more info visit frecompositesinc.com



©2023 Atkore. All rights reserved. FRE-FLYR-6156-2302

Instructions for Gasketed Joint System with our TriSeal®

Atkore™
FRE Composites

- Airtight / Watertight seal up to 75 Psi
- 500 lb pull out strength, regardless of diameter ¾" – 8"
- Comes standard in Epoxy System SW and HW

- Available for all fittings except sleeves and XW product
- Installed at the factory, with the retainer ring
- Retainer Ring is a black ring which finishes the end for a clean appearance



For more info visit frecompositesinc.com



©2023 Atkore. All rights reserved. FRE-FLYR-6156-2302